

Deed, SC, Richland, John Bryson, 1787

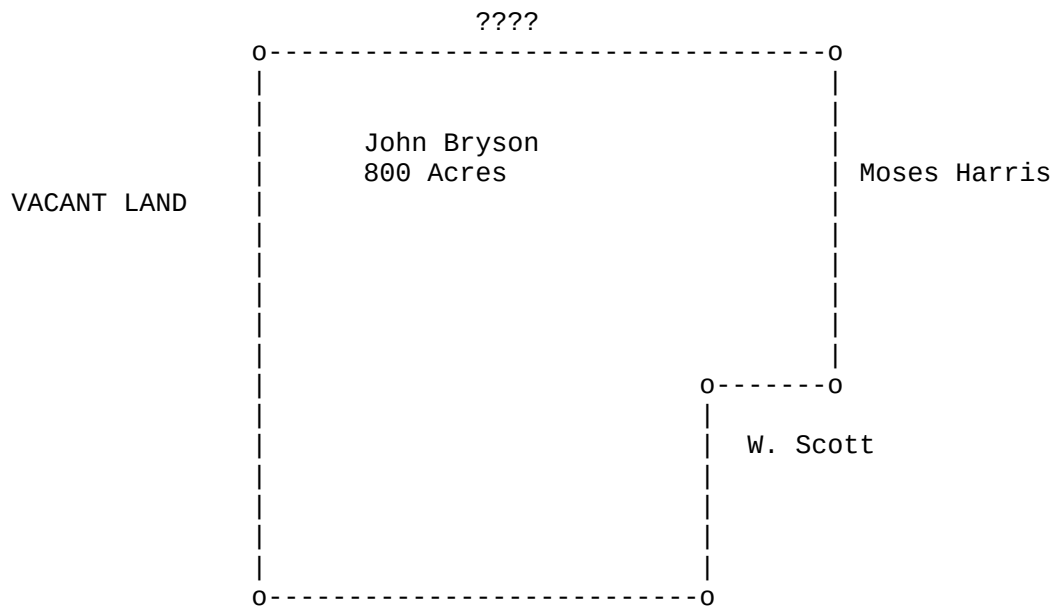

South Carolina

Pursuant to a warrant from **JOHN WINN** Esquire Commissioner land for Commissioner District I have laid out onto **JOHN BRYSON** a tract of land containing 800 acres situated on Toms Creek Waters of the Congaree and hath such shape and marks as the above plat represents

Surveyed 16th of August 1787

Records delivered him 25th of August

HENRY SMITH Deputy surveyor

Deed, SC, Richland, John Bryson, 1787

PLAT POINTS

=====

S56.5.33E 91.58

N23E 36.5c

S53E 12c

N23E 62.5c

N53W 79.5c

S37W 101c

Deed, SC, Richland, John Bryson, 1787

```
##### # # ##### ##### # # ##### ##### # #
# # ## ## # # # ## # # # # # ## ##
# # # # # # # # # # # # # # # # # #
##### # # # # ##### ##### # # #
# # # # # # # # # # # # # # #
# # # # # # # # # # ## ### # # # # #
##### # # ##### ##### # # ### ##### ##### # #
```

Transcribed from original documents by Brent R. Brian & Martha M. Brian.

This document and others can be found on our website:

[BMGEN](#)

We claim **COPYLEFT** on the documents that we publish that are our original work.

COPYLEFT "rules" can be reviewed on the web site:

[GNU Free Documentation License](#)

In short, use what you like. But if you use our stuff, mention us as the source.

Brent R. Brian

Martha M. Brian

BrianMitchellGenealogy@gmail.com