

**Deed, SC, Abbeville, Nathan Bryant, 1787**

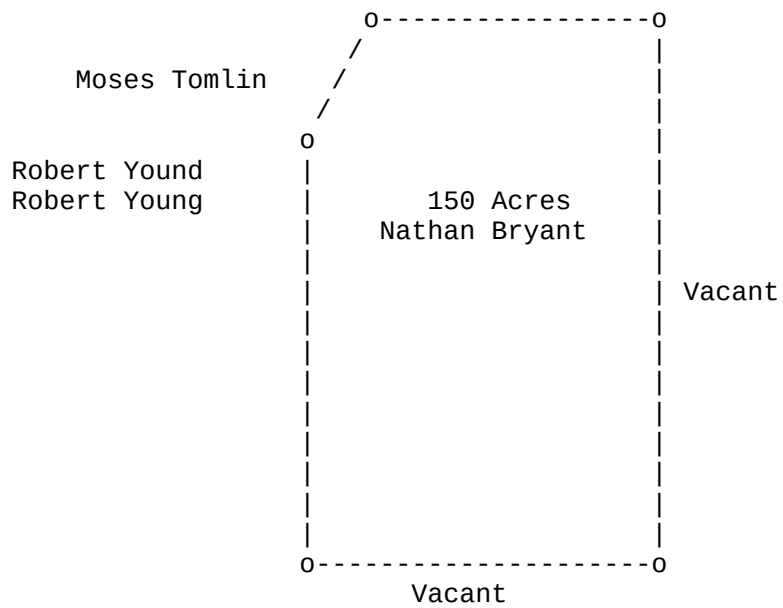

South Carolina

**NATHAN BRYANT** 150 Acres of land situate on the NE fork of Little Rocky Creek, a branch of Rocky River, above the line surveyed by **JONATHAN CLARKE**, D. S. on the 19<sup>th</sup> day of March last and recorded this 8<sup>th</sup> of June 1787.

**R. ANDERSON**, C. S.

[NATHAN BRIANT, NATHAN BRIAN, NATHAN BRYAN]

Deed, SC, Abbeville, Nathan Bryant, 1787

```
##### # # ##### ##### # # ##### ##### # #
# # ## ## # # # ## # # # # # ## ##
# # # # # # # # # # # # # # # # # #
##### # # # # ##### ##### # # #
# # # # # # # # # # # # # # #
# # # # # # # # # # ## ### # # # # #
##### # # ##### ##### # # ### ##### ##### # #
```

Transcribed from original documents by Brent R. Brian & Martha M. Brian.

This document and others can be found on our website:

[BMGEN](#)

We claim **COPYLEFT** on the documents that we publish that are our original work.

COPYLEFT "rules" can be reviewed on the web site:

[GNU Free Documentation License](#)

In short, use what you like. But if you use our stuff, mention us as the source.

Brent R. Brian

Martha M. Brian

[BrianMitchellGenealogy@gmail.com](mailto:BrianMitchellGenealogy@gmail.com)